

Adin implants: the obvious choice!

Trycare Ltd, the UK's fastest growing dental dealer, is the UK distributor for Adin Dental Implant Systems. Adin has been established for over two decades and is the world's tenth largest manufacturer of dental implants. It has been predicted that it will soon be in the top four. Clinical tests in universities and hundreds of thousands of successful restorations make Adin implants the obvious choice for many professionals worldwide.

Adin history

Adin has been around for 25 years, the same length of time as Ankylos implants. It is a global premier implant provider to over 65 countries and market leader in Israel and India. Adin implants is one of the fastest growing implant systems in the UK and a provider to BUPA and approved supplier to the London Royal College of Surgeons.

Adin implants were invented by four people from Israel, one of whom, Ami Hantman, was originally involved with Ophir Fromovitch in the development of the Alpha Bio implant, which was bought out by Nobel Biocare and led to the launch of Nobel Active.

Ami decided to work with Adin; he tweaked the original Nobel Active design – he domed the apex of the implant thus making it even more versatile. This means implantologists can use Adin implants in the sinus area with reduced risk of perforating the sinus floor, because the domed shape gives it a tenting effect – unlike implants which are very tapered at the apex and have more chance of perforating the sinus floor.

Adin sells over one million implants per year and, since its introduction in the UK, Trycare have sold over 40,000 Adin implants. They are very versatile and can be used in any indication.

Exceptional primary stability and orientation

Adin's spiral design implants are suitable for all indications and exceptional for immediate loading. Their surfaces have been treated for faster osseointegration and New York University research indicates that they integrate at least as well as Nobel, Straumann and Astra implants.

Their unique thread and tip slices through bone compressing and condensing on the way, offering outstanding primary stability and optimal restorative orientation.

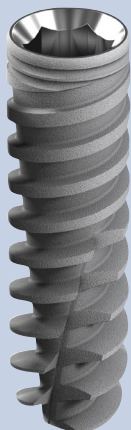

Touareg S with internal hex

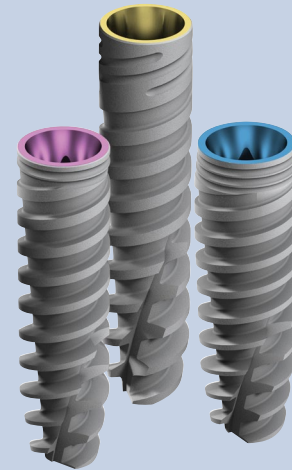

Touareg Closefit available in narrow, regular and wide platforms

A design which accelerates osseointegration

Adin implants have the latest surface treatment technology, which has been shown to increase osseointegration. They also feature macroscopic grooves on the surface of the implant thread. These operate together to double the surface area of most other implants and give better bone-to-implant contact. This promotes the crucial 'bonding' of the bone to the implant.

Soft and hard tissue preservation

For posterior applications, the coronal end of large-diameter Adin implants are back-tapered with platform switching to enhance soft tissue preservation. Simultaneously, their apical blades preserve the bone by slicing through it rather than cutting through it like other types of implants.

Ideally suited for the aesthetic zone

Adin spiral design implants have the capability to be redirected during placement with little or no reduction of stability. Even in this circumstance, the dual cutting blade edge design helps keep the osteotomy site and trauma to bone and surrounding soft tissue to a minimum. This makes them ideal for thinner ridge bone in the anterior aesthetic zone.

Adin offers a comprehensive selection of standard and special aesthetic abutments, which are made from the very best quality biologically compatible materials with outstanding homogeneity to meet almost all patients' aesthetic needs.

For further information visit the Trycare website, www.trycare.co.uk/adin, or request one of their Surgical Essentials and Adin Catalogues. To request a catalogue please contact your local representative or call 01274 885544.